

W

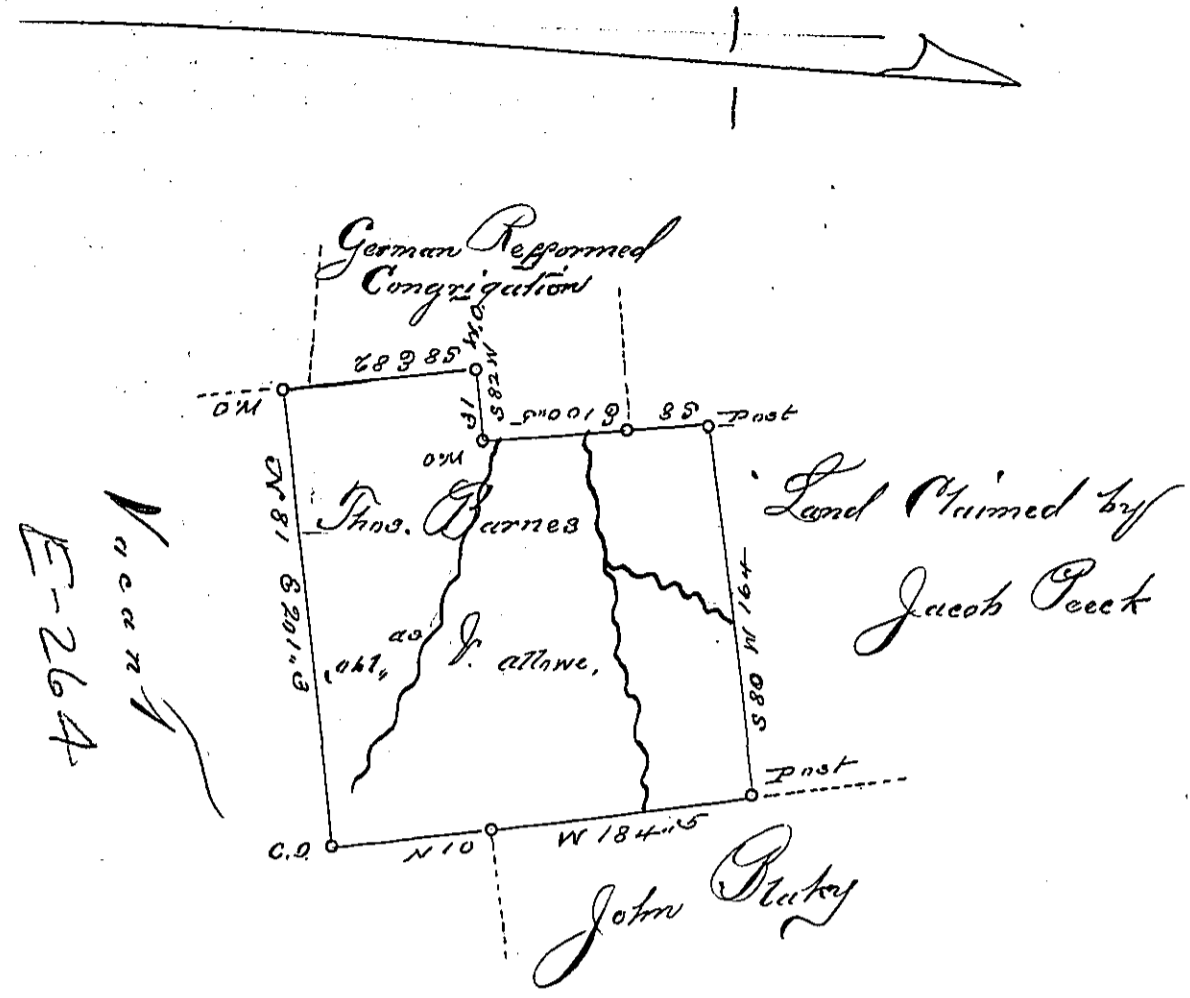

Draft of a tract of land Called mis Situate in the County of Luzerne
 Containing one Hundred & Ninety five Acres & Allowance Surveyed for
 Thos. Barnes the 12th day of Sept 1793 by virtue of a warrant Dated the
 9th day of August 1793

by Wm. Obl.

Daniel Brodhead Esqr
 Survr Genl.

IN TESTIMONY that the above is a copy of the original remaining on file in the
 Department of Internal Affairs of Pennsylvania, made con-
 formably to an Act of Assembly approved the 16th day of
 February, 1833, I have hereunto set my Hand and caused
 the Seal of said Department to be affixed at Harrisburg, this

Ninth day of April 1891

Wm. Stewart
 Secretary of Internal Affairs